

Application: on sheet metal and plastic material.
 Assembly: by specific manual of pneumatic tools.

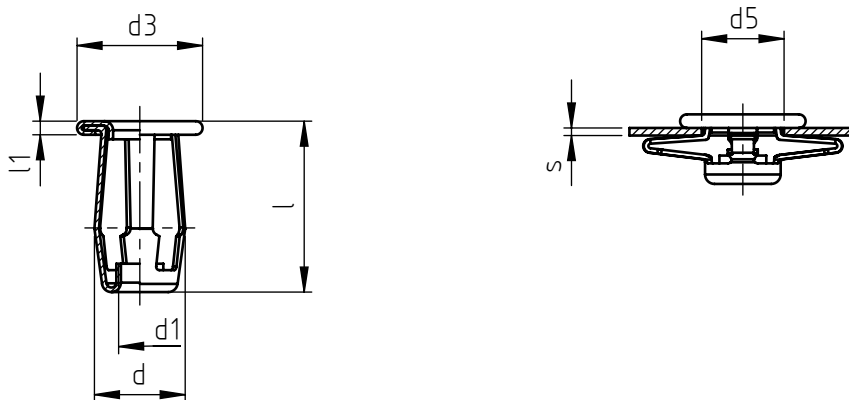

code steel insert	code stainless steel insert	s grip	l	d1	d	d3 Max	l1	d5
TC-F M 4	--	0,4 ÷ 4,8	16,8	M 4	8,2	12,3	1,6	8,3
TC-F/L M 4	--	4,8 ÷ 9,5	22,0					
TC-F M 5	TCX-F M 5	0,4 ÷ 4,8	18,5	M 5	10,1	14,5	1,6	10,3
TC-F/L M 5	--	4,8 ÷ 9,5	23,2					
TC-F M 6	--	0,4 ÷ 4,8	18,5	M 6	12	16,5	1,6	12,3
TC-F/L M 6	TCX-F/L M 6	4,8 ÷ 9,5	23,0					
TC-F M 8	--	0,4 ÷ 4,8	21,0	M 8	15,2	18,5	2	15,5
TC-F/L M 8	--	4,8 ÷ 8,0	25,0					
--	TCX-F/L M 8	5,0 ÷ 12,0	25,5					

Non binding dimensions, expressed in mm.

Standard
 On demand
 Not manufactured

Material: steel TC-F__
 stainless steel AISI 316 TCX-F__

Finishing: inserts in steel white zinc-plated
 inserts in stainless steel natural state

Thread: metric

Example: threaded flower insert in steel, grip 2,0 mm,
 M 5 thread:
 TC-F M 5

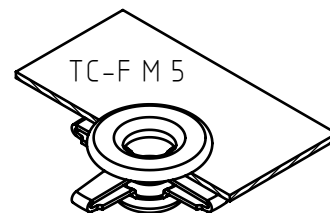

SPECIALINSERT® COMMITS ITSELF TO CONTINUOUSLY IMPROVE ITS PRODUCTS. IT RESERVES THE RIGHT TO CHANGE THEIR TECHNICAL AND STRUCTURAL CHARACTERISTICS WITHOUT PRIOR NOTICE. ALL RIGHTS ARE RESERVED AND THE DUPLICATE, EVEN PARTIAL OF THESE DOCUMENTS, AS WELL AS ITS DISTRIBUTION TO THIRD PARTIES ARE FORBIDDEN, UNLESS OTHERWISE AND EXPRESSLY AUTHORIZED BY SPECIALINSERT.