

Application: metal and not metal sheets.
Assembly: with special tools.

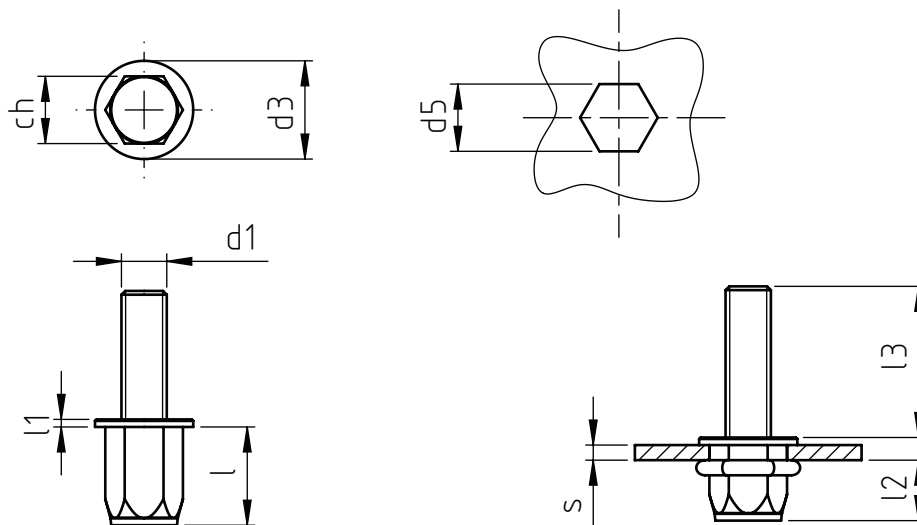

code	s	l	d1	l3 min	ch	d3	l1	d5	l2 *
ETCP M5X15	0,5-3	11	M5	15	6,9	10	1	7	5-5,5
ETCP M5X20	0,5-3	11	M5	20	6,9	10	1	7	5-5,5
ETCP M5X25	0,5-3	11	M5	25	6,9	10	1	7	5-5,5
ETCP M6X15	0,5-3	13	M6	15	8,9	13	1,5	9	7-7,5
ETCP M6X20	0,5-3	13	M6	20	8,9	13	1,5	9	7-7,5
ETCP M6X25	0,5-3	13	M6	25	8,9	13	1,5	9	7-7,5
ETCP M8X20	0,5-3	14	M8	20	10,9	16	1,5	11	8-8,5
ETCP M8X25	0,5-3	14	M8	25	10,9	16	1,5	11	8-8,5

Non binding dimensions, expressed in mm.

* Dimension determined from the average of the grip "s" min and max values.

Standard
 On demand
 Not manufactured

Material: screw: steel 8.8 class
rivet: cold formed steel
Finishing: white zinc-plated
Thread: ISO 6 g metric
Example: M 6 threaded stud rivet, 15 mm
long (l3) after deformation,
applied on a sheet with 2,00 mm
thickness:

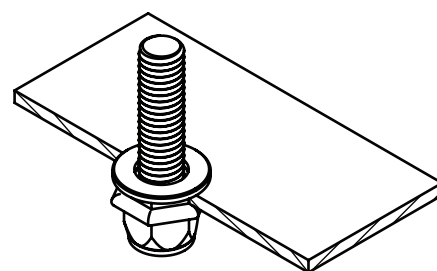

ETCP M6X20