

WHAT IT IS: Bi-Fix is a system that allows the rapid assembly of elements that are intended to be frequently removed. It is anti-vibration and does not require special tools for assembly.

HOW IT WORKS: by simply pressing the stud, while removal takes place by turning the same stud of a quarter of a turn.

APPLICATIONS: panels or doors of electrical panels, racks, machining centres, transport shelters, aviation, earth-moving machinery, scientific instrumentation, electronic equipment, inspection panels, heating systems, etc.

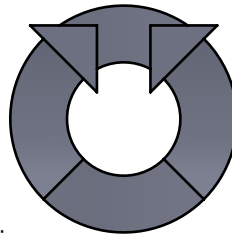

SERIES:

08 MINI Tensile loads up to 300N max

11 MEDIUM Tensile loads up to 900N max

16 MAXI Tensile loads up to 2000N max

Values are indicative and not binding, they are the result of laboratory tests that may not be repeatable with other methods of application

Lock through pressing the stud

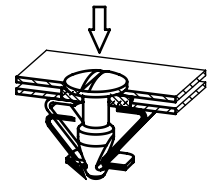

Turn the stud a quarter of a turn to unlock

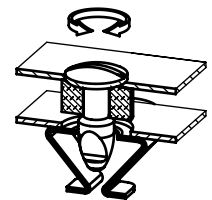

FASTENING ELEMENTS

D

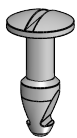

DOME HEAD

W



WING HEAD

K

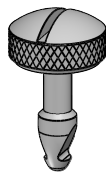

KNURLED HEAD

STUD: for each series the stud is produced in three different shapes, depending on the type of maneuverability you want to adopt.

ASSEMBLY SEQUENCE

STUD

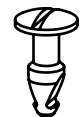

MOBILE PANEL



WASHER



FIXED PANEL



CLIP

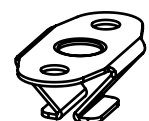

R



WASHER: manufactured in neoprene with different thicknesses, acts as an elastic spacer depending on the space between the parts to be assembled. Specific washers are available for mobile panels' surface protection and for waterproofing the fastening.

C



RIVETS

CP



SPOT WELDED

MSC

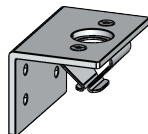

ANGLE PLATES

CC



CLIP-IN

CLIP: the spring-loaded device that receives the hooking of the stud, is produced in four versions, according to the type of assembly.

SPECIALINSERT® COMMITS ITSELF TO CONTINUOUSLY IMPROVE ITS PRODUCTS. IT RESERVES THE RIGHT TO CHANGE THEIR TECHNICAL AND STRUCTURAL CHARACTERISTICS WITHOUT PRIOR NOTICE. ALL RIGHTS ARE RESERVED AND THE DUPLICATE, EVEN PARTIAL OF THESE DOCUMENTS, AS WELL AS ITS DISTRIBUTION TO THIRD PARTIES ARE FORBIDDEN, UNLESS OTHERWISE AND EXPRESSLY AUTHORIZED BY SPECIALINSERT®.

D Stud

CODE	
D 0802	
D 0802,5	
D 0803	
D 0803,5	
D 0804	
D 0805	
D 0806	
D 0807	
D 0808	

W Stud

CODE	
W 0802	
W 0802,5	
W 0803	
W 0803,5	
W 0804	
W 0805	
W 0806	
W 0807	
W 0808	

K Stud

CODE	
-	
-	
K 0803	
-	
K 0804	
K 0805	
K 0806	
K 0807	
K 0808	

Assembly Dimension

H MAX	L	l
3,0	11,2	9,3
3,5	11,7	9,7
4,0	12,2	10,3
4,4	12,7	10,7
4,8	13,0	11,1
5,7	13,9	12,0
6,8	15,0	13,1
7,8	16,0	14,4
9,0	17,2	15,3

R Washer

CODE	S
R 0508	0,5
R 1208	1,2
R 1708	1,7
R 2508	2,5
R 3208	3,2
R 4808	4,8

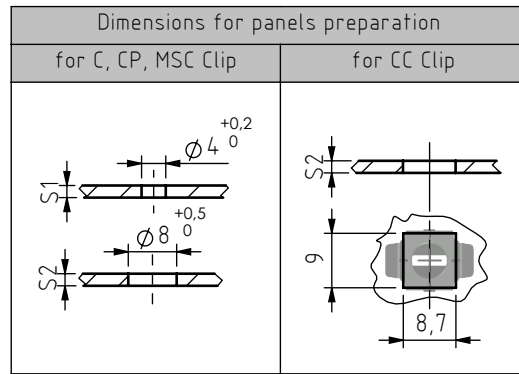
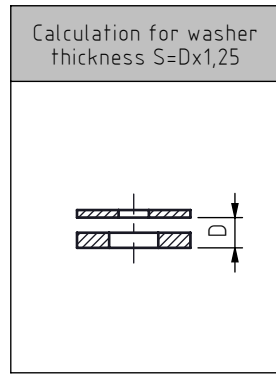

C Clip	MSC Clip	CC Clip																									
<p>C 08 (STEEL) C 08X (STAINLESS STEEL)</p>	<p>MSC 08/1</p>	<p>CC _/_ CC _/_IX</p>																									
<p>CP 08</p>		<table border="1"> <thead> <tr> <th>Steel</th> <th>Stainless steel</th> <th>A</th> <th>B</th> <th>S2</th> </tr> </thead> <tbody> <tr><td>CC 08/1</td><td>CC 08/1IX</td><td>18,5</td><td>6,9</td><td>0,5±1,0</td></tr> <tr><td>CC 08/2</td><td>CC 08/2IX</td><td>17,6</td><td>7,4</td><td>1,0±1,5</td></tr> <tr><td>CC 08/3</td><td>CC 08/3IX</td><td>16,6</td><td>7,9</td><td>1,5±2,0</td></tr> <tr><td>CC 08/4</td><td>CC 08/4IX</td><td>15,6</td><td>8,4</td><td>2,0±2,5</td></tr> </tbody> </table>	Steel	Stainless steel	A	B	S2	CC 08/1	CC 08/1IX	18,5	6,9	0,5±1,0	CC 08/2	CC 08/2IX	17,6	7,4	1,0±1,5	CC 08/3	CC 08/3IX	16,6	7,9	1,5±2,0	CC 08/4	CC 08/4IX	15,6	8,4	2,0±2,5
Steel	Stainless steel	A	B	S2																							
CC 08/1	CC 08/1IX	18,5	6,9	0,5±1,0																							
CC 08/2	CC 08/2IX	17,6	7,4	1,0±1,5																							
CC 08/3	CC 08/3IX	16,6	7,9	1,5±2,0																							
CC 08/4	CC 08/4IX	15,6	8,4	2,0±2,5																							

MATERIALS:

STUD - Nickel-plated brass, galvanised steel or stainless steel on request

WASHER - Neoprene

CLIP - White galvanised spring steel or stainless steel.

For more product information ask for the full BI-FIX catalogue.

It is advisable to perform tests to identify the correct choice of BI-FIX components.

Dimensions are indicative, not binding, expressed in mm.

D Stud	
CODE	
D 1103	
D 1104	
D 1105	
D 1106	
D 1107	
D 1108	
D 1109	
D 1110	
D 1111	
D 1112	
D 1114	
D 1116	
D 1118	
D 1120	
D 1122	

D Stud*	
CODE	
D 1103P	
D 1104P	
D 1105P	
D 1106P	
D 1107P	
D 1108P	
D 1109P	
D 1110P	
D 1111P	
D 1112P	

* P Series

W Stud	
CODE	
W 1103	
W 1104	
W 1105	
W 1106	
W 1107	
W 1108	
W 1109	
W 1110	
W 1111	
W 1112	
W 1114	
W 1116	
W 1118	
W 1120	
W 1122	

K Stud	
CODE	
K 1103	
K 1104	
K 1105	
K 1106	
K 1107	
K 1108	
-	
K 1110	
-	
K 1112	
K 1114	
K 1116	
K 1118	
K 1120	
K 1122	

Assembly Dimension		
H MAX	L	l
3,7	16,6	14,4
4,7	17,6	15,4
5,7	18,6	16,4
6,9	19,8	17,6
7,7	20,6	18,4
8,9	21,8	19,6
9,7	22,6	20,4
10,7	23,6	21,4
11,7	24,6	22,4
12,9	25,8	23,6
14,7	27,6	25,4
16,7	29,6	27,4
18,7	31,6	29,4
20,9	33,8	31,6
22,7	35,6	33,4

R Washer	
CODE	S
R 1711	1,7
R 2511	2,5
R 4011	4,0
R 5011	5,0
R 6011	6,0

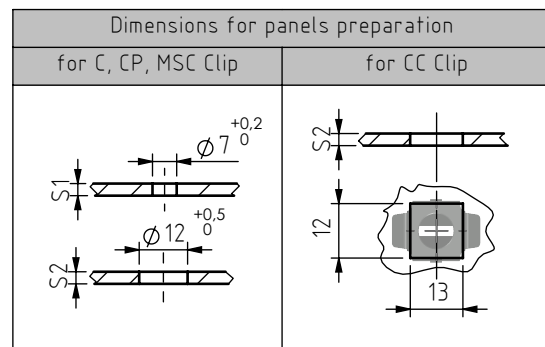
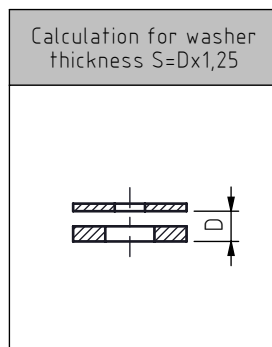

C Clip	
C 11 (STEEL)	
C 11X (STAINLESS STEEL)	
CP Clip	
CP 11	

MSC Clip	
MSC 11/1	

CC Clip				
CC _/_ /_IX				
Steel	Stainless steel	A	B	S2
CC 11/1	CC 11/11X	23,9	11,6	0,6÷1,2
CC 11/2	CC 11/21X	22,3	12,4	1,2÷2,0
CC 11/3	CC 11/31X	21,0	13,3	2,0÷2,8

MATERIALS:

STUD - Nickel-plated brass, galvanised steel or stainless steel on request; *P series: plastic stud in polyamide

WASHER - Neoprene

CLIP - White galvanised spring steel or stainless steel.

For more product information ask for the full BI-FIX catalogue.

It is advisable to perform tests to identify the correct choice of BI-FIX components.

Dimensions are indicative, not binding, expressed in mm.

D Stud	
CODE	
D 1604	
D 1606	
D 1608	
D 1610	
D 1612	
D 1614	
D 1616	
D 1618	
D 1620	

W Stud	
CODE	
W 1604	
W 1606	
W 1608	
W 1610	
W 1612	
W 1614	
W 1616	
W 1618	
W 1620	

K Stud	
CODE	
-	
W 1606	
W 1608	
W 1610	
W 1612	
W 1614	
W 1616	
W 1618	
W 1620	

Assembly Dimension		
H MAX	L	l
5,0	22,2	18,4
7,0	24,2	20,4
9,0	26,2	22,4
11	28,1	24,3
13	30,1	26,3
15,2	32,4	28,6
17	34,1	30,3
18,8	36	32,2
21	38,1	34,3

R Washer	
CODE	S
R 1716	1,7
R 2516	2,5
R 4016	4,0
R 5616	5,6

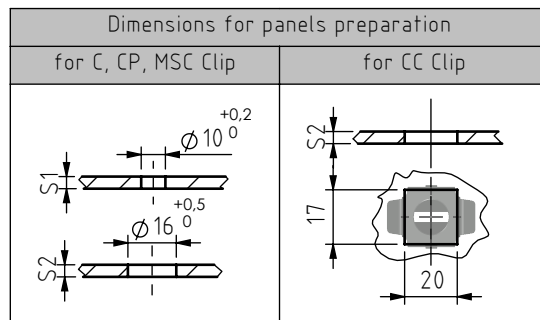
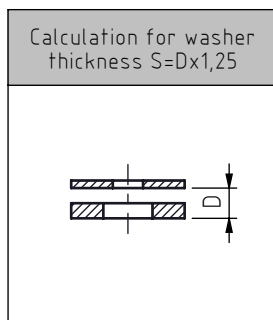

C Clip	MSC Clip	CC Clip																									
C 16 (STEEL)		CC __/__/																									
C 16X (STAINLESS STEEL)		CC __/__/IX																									
CP Clip																											
CP 16	MSC 16/1	<table border="1"> <thead> <tr> <th>Steel</th> <th>Stainless steel</th> <th>A</th> <th>B</th> <th>S2</th> </tr> </thead> <tbody> <tr><td>CC 16/1</td><td>CC 16/1IX</td><td>35,0</td><td>14,4</td><td>0,8÷1,7</td></tr> <tr><td>CC 16/2</td><td>CC 16/2IX</td><td>33,0</td><td>15,3</td><td>1,7÷2,7</td></tr> <tr><td>CC 16/3</td><td>CC 16/3IX</td><td>31,0</td><td>16,3</td><td>2,7÷3,7</td></tr> <tr><td>CC 16/4</td><td>CC 16/4IX</td><td>29,0</td><td>17,3</td><td>3,7÷4,7</td></tr> </tbody> </table>	Steel	Stainless steel	A	B	S2	CC 16/1	CC 16/1IX	35,0	14,4	0,8÷1,7	CC 16/2	CC 16/2IX	33,0	15,3	1,7÷2,7	CC 16/3	CC 16/3IX	31,0	16,3	2,7÷3,7	CC 16/4	CC 16/4IX	29,0	17,3	3,7÷4,7
Steel	Stainless steel	A	B	S2																							
CC 16/1	CC 16/1IX	35,0	14,4	0,8÷1,7																							
CC 16/2	CC 16/2IX	33,0	15,3	1,7÷2,7																							
CC 16/3	CC 16/3IX	31,0	16,3	2,7÷3,7																							
CC 16/4	CC 16/4IX	29,0	17,3	3,7÷4,7																							

MATERIALS:

STUD - Nickel-plated brass, galvanised steel or stainless steel on request

WASHER - Neoprene

CLIP - White galvanised spring steel or stainless steel.

For more product information ask for the full BI-FIX catalogue.

It is advisable to perform tests to identify the correct choice of BI-FIX components.

Dimensions are indicative, not binding, expressed in mm.