

Applications: on threaded materials (see external diameter d2).
 Assembly: by screwing.

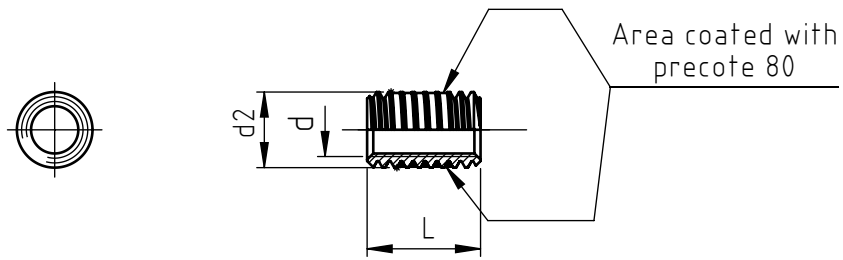

code	total length L
971___	1 d
972___	1,5 d
973___	2 d
974___	2,5 d

code	internal thread d	external thread d2	standard lengths			
			1 d	1,5 d	2 d	2,5 d
___0030__	M 3	M 5		4,5	6	
___0040__	M 4	M 6		6	8	10
___0050__	M 5	M 7		7,5	10	12,5
___0060__	M 6	M 8		9	12	15
___0080__	M 8	M 12		12	16	20
___0100__	M 10	M 14		15	20	25
___0120__	M 12	M 16	12	18	24	30

Non binding dimensions, expressed in mm.

part: cutting resistance N/mm ²	screw: resistance class	suggested lengths				
		M 3	M 4	M 5	M 6- M 10	M 12
≥ 70	4,8	2 d	1,5 d	2 d	2 d	-
≥ 140	4,8	2 d	1,5 d	2 d	1,5 d	1 d
	6,8	2 d	1,5 d	2 d	1,5 d	1,5 d
	8,8	2 d	1,5 d	2 d	2 d	2 d
≥ 210	6,8	2 d	1,5 d	2 d	1,5 d	1 d
	8,8	2 d	1,5 d	2 d	1,5 d	1,5 d
	12,9	2 d	1,5 d	2 d	1,5 d	2 d
	14,9	2 d	2 d	2 d	2 d	2,5 d
≥ 280	6,8	2 d	1,5 d	2 d	1,5 d	1 d
	8,8 ÷ 12,9	2 d	1,5 d	2 d	1,5 d	1,5 d
	14,9	2 d	1,5 d	2 d	1,5 d	2 d

Example: part cutting resistance ~ 160 N/mm², M6 screw class 8.8,
 suggested length: 2d = 12 mm.

Standard
 On demand
 Not manufactured

Material: steel (other materials on demand)
 Finishing: zinc-plated _____ .10
 Precote 80 glue coating (red) _____ .16
 Tolerances: length L ±0,25
 Threading: internal ISO 6H
 external metric
 Example: Mubux® - M 970, length 2d, M5 internal thread,
 M 7 external thread, steel, coating Precote 80:
 973 0050.16

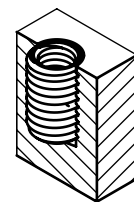

SPECIALINSERT® COMMITS ITSELF TO CONTINUOUSLY IMPROVE ITS PRODUCTS. IT RESERVES THE RIGHT TO CHANGE THEIR TECHNICAL AND STRUCTURAL CHARACTERISTICS WITHOUT PRIOR NOTICE. ALL RIGHTS ARE RESERVED AND THE DUPLICATE, EVEN PARTIAL OF THESE DOCUMENTS, AS WELL AS ITS DISTRIBUTION TO THIRD PARTIES ARE FORBIDDEN, UNLESS OTHERWISE AND EXPRESSLY AUTHORIZED BY SPECIALINSERT.